

MARINE & IRRIGATION COUPLINGS & ADAPTERS



Hayes Manufacturing, Inc.

6875 US Highway 131

Fife Lake, MI 49633

Phone: 231-879-3372 | Fax: 231-879-4330

www.hayescouplings.com

HAYES[®]

We've Got Connections

POWER
TRANSMISSION
PRODUCTS

Marine and Irrigation Couplings

There are thousands of Hayes marine and irrigation couplings and adapters in service throughout the world. They are used in gas and diesel engine applications where torsional vibration occurs. Our flexible neoprene elements absorb vibration and reduce shock loads (while providing a steady dampening effect)

The coupling takes up very little space while transmitting a surprising amount of torque. They're available with a wide variety of spline and bores & key options that come ready to bolt to your flywheel. The splines do not lock onto the shaft in order to allow for axial movement. This is similar to a drive shaft assembly in automotive applications.

All components have been designed for maximum life (when operated at normal engine speeds, torque and alignment). Please call your local distributor or our factory for assistance.

Design Characteristics:

Steel Yellow Zinc Trivalent Flywheel Plate

- Sturdy, steel plate for continuous load support.
- Yellow Zinc plating to protect against corrosive wear.

Adapters

- Hurth transmission
- SAE

Drive Hub

- Precision machined for consistent quality
- Heat-treated splines to prevent premature shaft wear
- Multiple hub lengths for easy installation in any standard SAE or non-standard application

Features and Advantages:

- Absorbs vibration and shock loads (maximizing the life of your pump components)
- Provides a steady dampening effect under load
- Designed for maximum life (when operated at normal engine speeds, torque and alignment)
- Rugged steel construction
- Eliminates human error with our easy, one-piece design (perfect for a production environment)!
- Operating temperatures: -40 to +220 F
- Various series for standard SAE flywheels and non-standard flywheels (including engine housings)
- Competitively priced and normally in stock
- Spline lubrication packaged and provided by Hayes.

Applications:

- Water Pumps • Marine Transmissions • Sprayers • Gear Boxes • and more.
- Consult factory for applications not listed

CALL US TO DISCUSS YOUR SPECIFIC APPLICATION REQUIREMENTS

Standard SAE Flywheel Coupling and Pump Mount Information

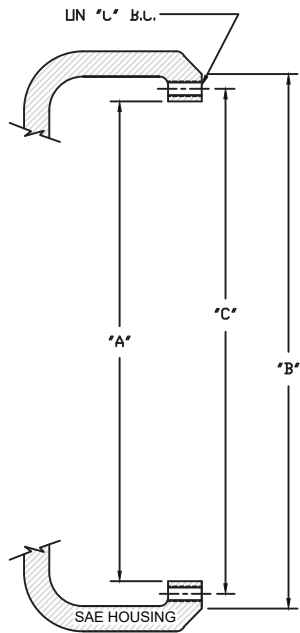

HAYES SAE PUMP MOUNTING PLATE DIMENSIONS						
HOUSING SIZE	"A" PILOT	"B" O.D.	"C" B.C.	PLATE THICKNESS	"D" MOUNTING PLATE HOLES	
					# OF HOLES	SIZE
1	20.125	21.750	20.875	1" OR 5/8"	12	31/64
2	17.625	19.250	18.375	1" OR 5/8"	12	27/64
3	16.125	17.750	16.875	5/8"	12	27/64
4	14.250	15.880	15.000	5/8"	12	27/64
5	12.375	14.000	13.130	5/8"	8	27/64
6	10.500	12.120	11.250	5/8"	8	27/64

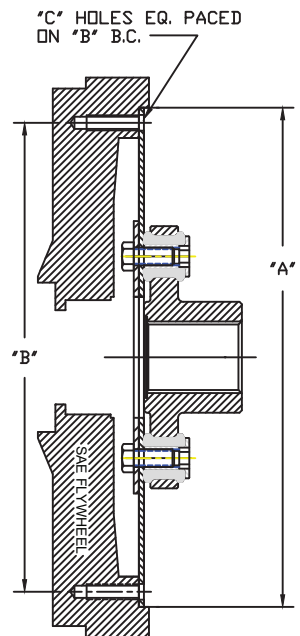

HAYES SAE FLYWHEEL PLATE DIMENSIONS				
SAE FLYWHEEL SIZE J620	"A" O.D.	"B" B.C.	# OF HOLES	"C" HOLE SIZE
6-1/2	8.499	7.875	6	0.343
7-1/2	9.499	8.750	8	0.343
8	10.374	9.625	6	0.406
10	12.374	11.625	8	0.406
11-1/2	13.874	13.125	8	0.406
14	18.375	17.250	8	0.531
16	20.375	19.250	8	0.531

Hayes Manufacturing, Inc.

6875 US Highway 131

Fife Lake, MI 49633

Phone: 231-879-3372 | Fax: 231-879-4330

www.hayescouplings.com



**POWER
TRANSMISSION
PRODUCTS**

Easy fill in the blank coupling specification (Just fill in then email or fax)

Name: _____

Company: _____

Phone: _____

Email: _____

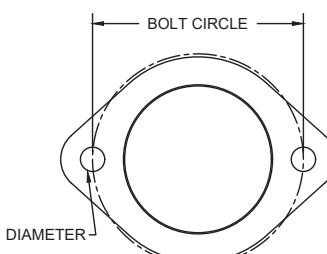
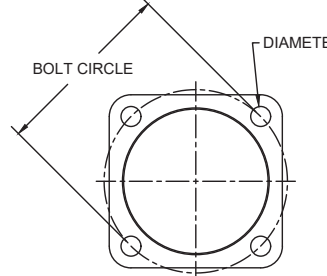
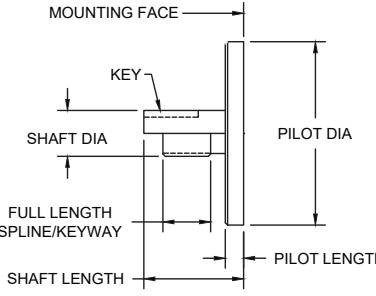
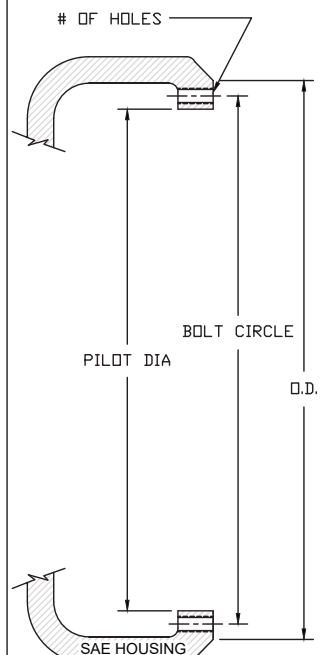
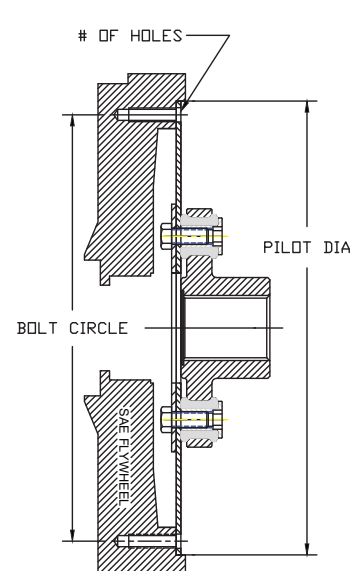
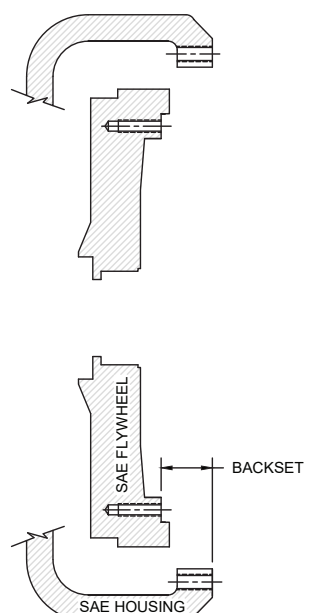
 <p>2-BOLT PUMP FACE</p>	 <p>4-BOLT PUMP FACE</p>	
<p><u>FLYWHEEL DATA</u></p> <p>PILOT DIA _____</p> <p>BOLT CIRCLE _____</p> <p># OF HOLES _____</p> <p><u>FLYWHEEL HOUSING DATA</u></p> <p>PILOT DIA _____</p> <p>BOLT CIRCLE _____</p> <p>O.D. _____</p> <p># OF HOLES _____</p> <p><u>FLYWHEEL TO HOUSING</u></p> <p>BACKSET _____</p>	<p><u>STANDARD DATA</u></p> <p>PILOT DIA _____</p> <p>SHAFT DIA _____</p> <p>SHAFT LENGTH _____</p> <p>KEY WIDTH _____</p> <p>FULL KEY/SPLINE LENGTH _____</p> <p>PILOT LENGTH _____</p> <p><u>SPLINE DATA</u></p> <p># OF TEETH _____</p> <p>D.P. _____</p> <p>P.A. _____</p> <div style="text-align: center;"><p>PUMP SHAFT INFORMATION</p></div>	
 <p>SAE HOUSING</p>	 <p>SAE FLYWHEEL</p>	 <p>BACKSET</p>